

# SPARE PARTS LIST

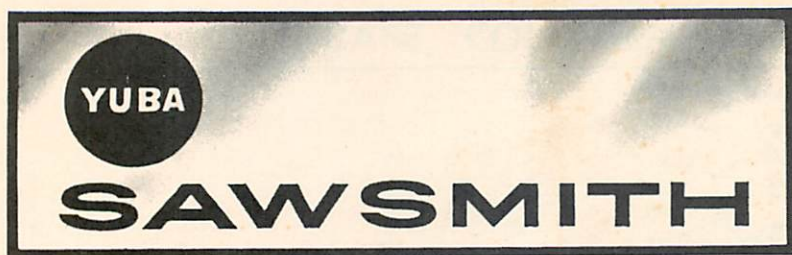

Item No. 700000  
Article No. 84-2265

## IMPORTANT INSTRUCTIONS

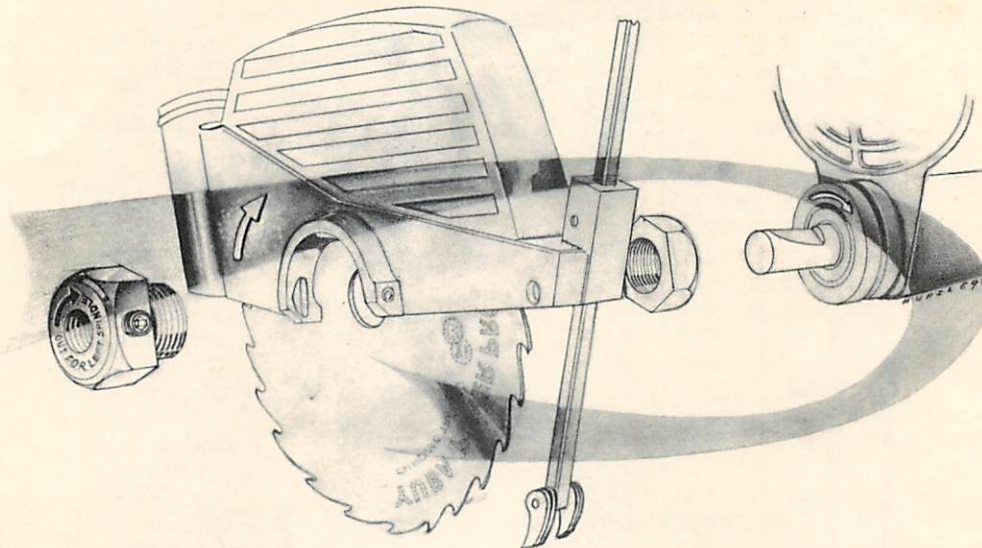

### FOLLOW THE ARROWS

It is most important that the above illustration be studied prior to the assembly of the saw blade and arbor or the assembly of the arbor on the spindle shaft. The arrow on the saw guard should always point in the direction of rotation.

When placing the 1-1/4" arbor on a saw blade, always keep the "Logo", printed on the saw blade, on the nut side of the arbor. A good procedure for assembly is to lay the arbor on a flat surface with the threads up, lower the saw blade over the arbor, with the blade teeth pointing toward you on the left

side, and start the nut on the arbor. Following this procedure will assure proper assembly of the saw blade and arbor.

To assure proper assembly of the arbor on the spindle, the following procedure should be used. When placing the arbor on the left spindle end, the arbor set screw should be between the blade and the end of the shaft. When placing the arbor on the right spindle end, the arbor set screw should be between the blade and the cradle casting.

### SERVICE

Your SAWSMITH carries a one-year warranty against defective materials or workmanship, provided you signed and returned the warranty card that came with your machine. Should you have occasion for repair or replacement of a part under warranty, contact your SAWSMITH dealer. He has current repair information and part prices.

Many SAWSMITH dealers maintain a stock of replacement parts and can give excellent mechanical service.

If an individual part is not included in the parts list, or shown on the exploded drawing, it is not sold separately.

**YUBA POWER PRODUCTS, INC.**  
800 EVANS ST., CINCINNATI 4, OHIO

A Subsidiary of  
**YUBA CONSOLIDATED INDUSTRIES, INC.**



# PARTS FOR BASE, COLUMN, ARM AND TABLE

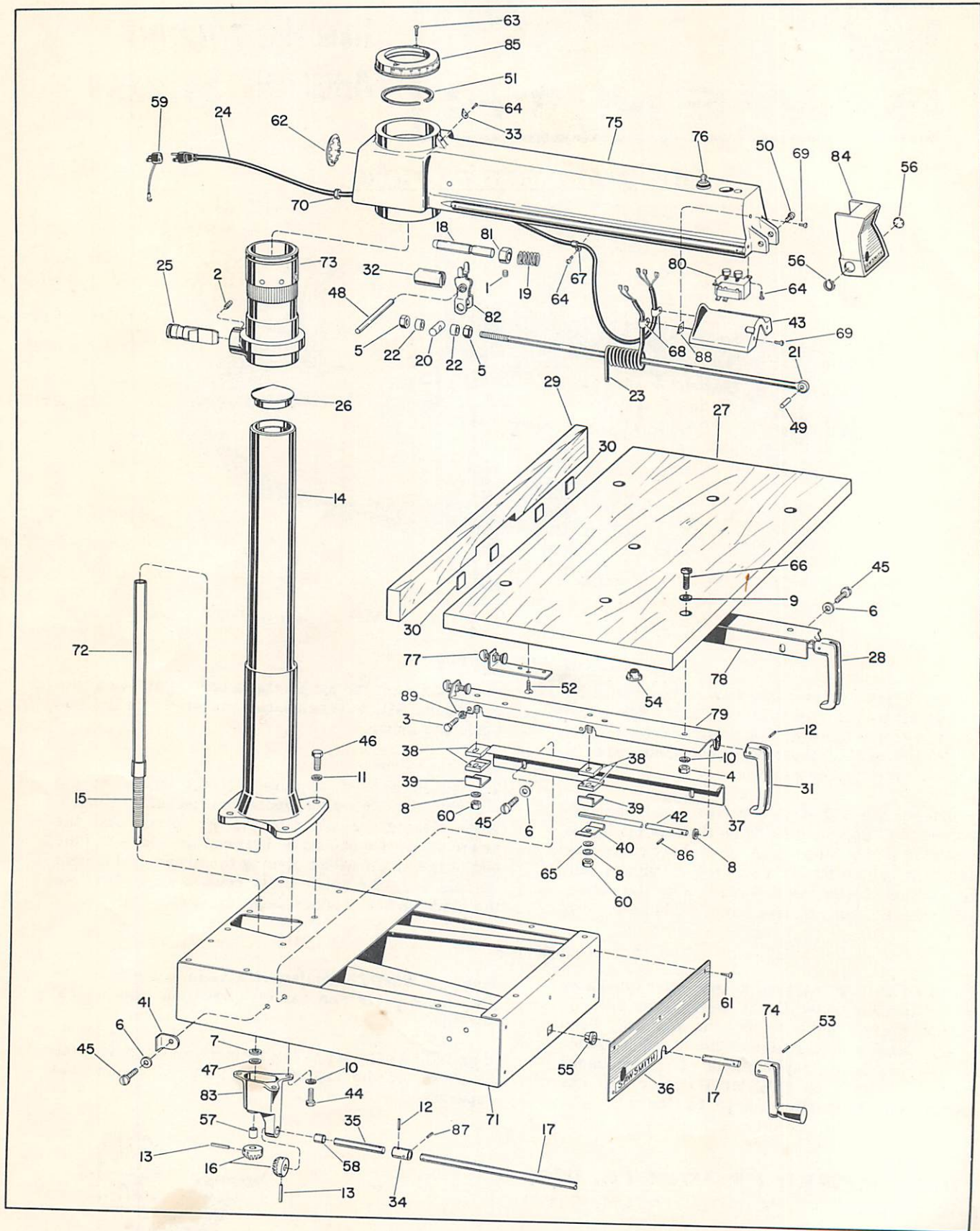

See page 5 for Parts List.

# PARTS FOR MOTOR-CARRIAGE ASSEMBLY

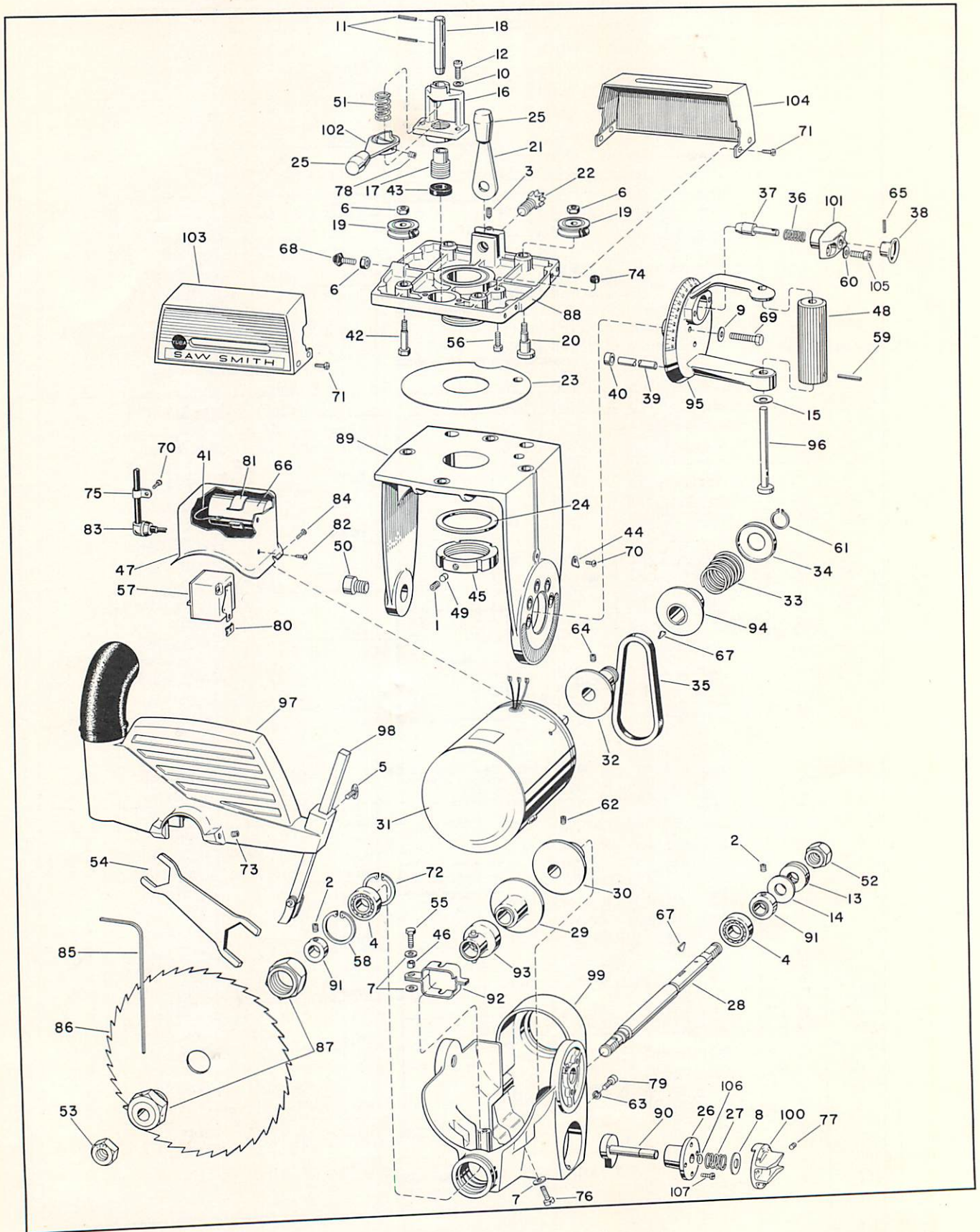

See page 4 for Parts List.

# PARTS LIST FOR MOTOR-CARRIAGE ASSEMBLY

REF. NO.	PART NO.	DESCRIPTION	REF. NO.	PART NO.	DESCRIPTION
1	1014	Set Screw, 5/16"-18 NC x 5/16" L., Cup Point	57	6478	Relay
2	1017	Set Screw	58	6481	Snap Ring-Beveled (Truarc N5002-156)
3	1075	Set Screw, 5/16"-18 x 5/8" L., Cone Point	59	6488	Pin-Roll, 1/8" x 1-1/8" L.
4	6693	Bearing	60	6490	Lockwasher, 5/16" Nom. I.D., Hi-Collar
5	1309	Thumb Screw, 1/4"-20 x 1/2" L.	61	6492	Ring-Retaining
6	1409	Hex Nut, 5/16" - 18, Jam Lock	62	1061	Set Screw 5/16-18 x 3/8"
7	1501	Washer, 1/4" Nom. I.D.	63	6604	Lockwasher, 1/4" Nom. I.D., Hi-Collar
8	1502	Washer, 3/8" Nom. I.D.	64	6606	Set Screw, 5/16"-24 x 1/4" L., Cup Point
9	1527	Lockwasher, 5/16" Nom. I.D.	65	6609	Roll Pin, 3/32" x 1/2" L.
10	1538	Lockwasher, 5/16" Nom. I.D.	66	6610	Capacitor
11	1638	Pin - Roll, 1/8" x 1" L.	67	6620	Key - Hi-Pro
12	2078	Cap Screw, 5/16"-18 x 5/8" L., Socket Hd.	68	6635	Stop-Rubber, Threaded Shank
13	2355	Washer	69	6343	Cap Screw, 5/16"-18 x 1-1/2" L., Hex Head
14	3560	Washer	70	6651	Sem, #8-32 x 3/8" L., Self Tapping
15	4604	Washer-Spring	71	6652	Sem, #10-24 x 3/8" L., Self Tapping
16	4703	Mount-Lock	72	6653	Snap Ring (Truarc 5008-156)
17	4704	Screw-Clamp	73	6657	Set Screw, 5/16"-18 x 5/8" L., Cone Point Socket Set
18	4706	Pin-Yoke Lock	74	6659	Cap-Bumper
19	4708	Glide Bearing	75	6660	Clip-Wire
20	4710	Eccentric	76	6662	Screw, 1/4"-20 x 5/8" L., Pan Hd., Slotted
21	4712	Handle-Carriage Lock	77	6664	Set Screw, #10-24 x 3/8" L.
22	4714	Screw-Jam, 1/2"-13 L.H. Thd.	78	1060	Set Screw, #10-24 NC x 1/4" L., Cup Point, Hex Socket
23	4716	Shim	79	6666	Cap Screw, 1/4"-20 x 2-1/4" L., Fill Hd.
24	4718	Washer	80	6667	Speed Nut-#8A Tinnerman
25	4724	Knob-Plastic	81	6668	Clip-Capacitor
26	4727	Locator-Speed	82	6669	Screw, #8A x 1/2" L., Rd. Hd.
27	4728	Spring	83	6674	Bushing-Strain Relief
28	4732	Shaft-Spindle	84	6675	Screw, #10Z x 5/16" L., Pan Hd.
29	4738	Pulley-Moveable Half	85	12028	Wrench-Allen, 5/32" L.
30	4739	Pulley-Fixed Half	86	22051	Blade-Saw
31	4741	Motor, 1 H.P., G.E.	87	27032	1-1/4" Arbor-Saw
	4871	Motor-Dual Voltage	88	700014	Carriage Assembly
32	4742	Sheave, Friction	89	700015	Yoke Casting Assembly
33	4745	Spring	90	700020	Shaft Assembly-Cam
34	4746	Retainer-Spring	91	700021	Collar Assembly
35	4747	Belt-Drive	92	700022	Yoke Assembly-Shaft
36	4751	Spring	93	700023	Bearing & Cup Assembly
37	4752	Pin-Locating	94	700027	Sheave Assembly-Spring
38	4753	Knob	95	700030	Handle Assembly-Cradle Control
39	4759	Pin-Cradle Lock	96	700032	Cam Shaft Assembly
40	4760	Plug-Cradle	97	700038	Guard Assembly
41	4791	Connection	98	700040	Anti-Kickback Assembly
42	4792	Bolt-Special	99	700042	Cradle & Cover Assembly
43	4801	Ring-Friction	100	700046	Dial Assembly
44	4808	Pointer	101	700050	Mount Assembly-Index
45	4841	Nut-Pivot	102	700055	Handle Weldment
46	4846	Spacer, 3/8" O.D. x 1/4" I.D. Nom.	103	700062	Cover Assembly, L.H.
47	4847	Box	104	700063	Cover Assembly, R.H.
48	4849	Handle-Twist Lock	105	4880	Cap Screw 5/16-18 x 1" L.
49	4851	Plug-Nylon	106	1650	Retaining Ring
50	4852	Cap Screw, 1/2"-13 x 1/2" L., Socket Hd. Special	107	6680	Machine Screw, #10-24 x 5/8" L.
51	4853	Spring			
52	4861	Nut-Spindle, R.H.			
53	4864	Nut-Spindle, L.H.			
54	4868	Wrench-Arbor			
55	6307	Hex Bolt, 1/4"-20 x 3/4" L.			
56	6463	Cap Screw, 1/4"-20 x 5/8" L., Socket Hd.			

See page 3 for Illustration.

# PARTS LIST FOR BASE, COLUMN, ARM AND TABLE

REF. NO.	PART NO.	DESCRIPTION	REF. NO.	PART NO.	DESCRIPTION
1	1019	Set Screw, 1/4"-28 x 1/4" L., Cup Point	47	6464	Washer-Thrust
2	1058	Set Screw, 5/16"-18 x 3/8" L., Flat Point	48	6472	Pin-Drive-Lok, 3/8" x 2" L., Type "C"
3	6307	Hex Bolt, 1/4"-20 x 3/4" L.	49	6473	Pin-Drive-Lok, 5/16" x 1" L.
4	1414	Hex Nut, 5/16" - 18	50	6474	Cap Screw, 5/16"-18 x 5/16" L., Socket Hd.
5	1482	Hex Nut, 5/16" - 18, Gripo Jam	51	6475	Snap Ring
6	1501	Washer, 1/4" Nom. I.D.	52	6494	Screw-Wood, #12 x 3/4" L., Flat Hd.
7	1502	Washer, 3/8" Nom. I.D.	53	6573	Pin-Roll, 3/16" x 3/4" L.
8	1510	Washer, 5/16" Nom. I.D.	54	6611	Nut-Tee, 5/16" - 18
9	1530	Washer, 5/16" Nom. I.D.	55	6625	Grommet (Fastex #218-320402-01)
10	1538	Lockwasher, 5/16" Nom. I.D.	56	6637	Plug-Hole
11	1546	Lockwasher, 3/8" Nom. I.D.	57	6639	Bushing
12	1609	Pin-Roll, 1/8" x 3/4" L.	58	6640	Bushing
13	1638	Pin-Roll, 1/8" x 1" L.	59	6642	Adapter-Plug
14	4670	Column	60	6644	Hex Nut-Center Lock, 5/16" - 18
15	4674	Shaft-Screw	61	6648	Sheet Metal Screw, #6 x 1/2" L., Phill. Hd.
16	4676	Gear-Bevel	62	6649	Plug-Hole
17	4677	Shaft-Riser	63	6650	Sem, #6-32 x 1/2" L., Self Tapping
18	4683	Pin-Arm Indexing	64	6651	Sem, #8-32 x 3/8" L., Self Tapping
19	4684	Spring	65	6654	Washer-Spring
20	4685	Pin-Pivot	66	6656	Machine Screw, 5/16"-18 x 1-1/4" L. Pan Hd.
21	4686	Rod-Lock	67	6660	Clip-Wire
22	4687	Spacer	68	6670	Clamp
23	4694	Wire-Coiled	69	6681	Screw, #8Z x 7/8" L.
24	4698	Wire-Main, with Plug	70	6673	Grommet
25	4700	Pin-Collar	71	700003	Base Weldment
26	4701	Cap	72	700007	Tube Assembly
27	4761	Table	73	700010	Collar Assembly
28	4769	Handle, R.H.	74	700017	Crank Assembly-Hand
29	4770	Fence	75	700043	Arm & Track Assembly
30	4771	Spacer	76	700048	Lock Assembly-With Key
31	4776	Handle, L.H.	77	700049	Bracket Assembly-Aux. Fence
32	4807	Pin-Arm Lock	78	700051	Channel Assembly, R.H.
33	4808	Pointer	79	700052	Channel Assembly, L.H.
34	4817	Coupling	80	700057	Switch Assembly
35	4818	Shaft-Stub	81	700058	Collar Assembly
36	4822	Logo-Plate	82	700059	Plate Assembly-Lever
37	4836	Rail	83	700060	Bracket Assembly - Gear (Incl. Ref. Nos. 57 & 58)
38	4837	Guide	84	700061	Handle Assembly-Arm Lock
39	4838	Plate	85	700064	Cap Assembly-Miter
40	4839	Clamp	86	6597	Roll Pin, 1/8" x 1/2" L.
41	4840	Cam Lift	87	6683	Groove Pin
42	4843	Rod-Lock	88	6694	Speed Nut
43	4860	Shield	89	1406	Lock Nut, 1/4" - 20
44	6353	Hex Bolt, 5/16"-18 x 3/4" L.			
45	6367	Screw, 1/4"-20 x 1/2" L., Slotted Pan Hd.			
46	6456	Cap Screw, 3/8"-16 x 1" L., Hex Hd.			

See page 2 for Illustration.

